

acaia

GET STARTED

Need help? Contact us at support@acaia.co

TITAN BREW STAND

Congratulations on your purchase of the Acaia Titan brew stand. This quick start guide will walk you through the basics of how to set up and use your Titan.

Made of durable aluminum alloy material, the Titan is built to the highest standards of quality. The streamlined design makes the Titan easy to disassemble, store, and clean. Form and functionality combine to offer you an entirely new experience of using brew stands.

The Titan can be used in combination with Acaia scales to precisely measure the ratio between coffee and brew. Its durable design also allows it to withstand the downward force when extracting an AeroPress®.

AeroPress® Setup

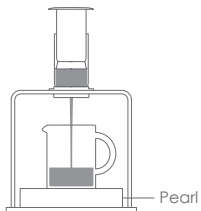

Coffee To Beverage
Ratio Setup

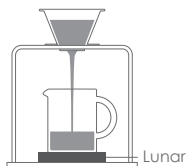

To learn more about the Titan, scan the QR code and get started at acaia.co/titan



ASSEMBLY GUIDE

Titan Base Filter Supports Screws Anti-slip Pads



1 BEGIN ASSEMBLY

Turn the Titan upside down and use the four screws to secure the supports to the base.

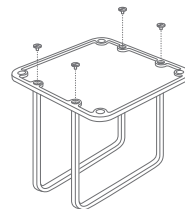

2 MOUNT THE BASE

Fasten the filter supports to the base by using a coin to tighten the screws.

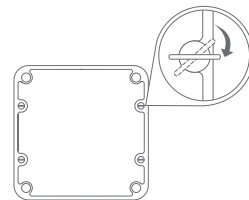

3 ATTACH ANTI-SLIP PADS

Remove the adhesive from the anti-slip pads. Press to attach the pads to the screw holes and corners.

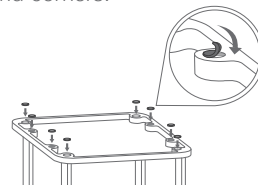

4 ASSEMBLY COMPLETE

Turn the stand over. Ensure that the base is firmly attached.

